



the Bella clutch



Materials:

- ✿ Outside:
 - 5 - 2 ½" x 13" Strips (body)
 - 2 - 2" x 8 ½" Strip (band)
- ✿ Lining: 1 Fat Quarter (or scraps from *the Anne handbag* lining)
- ✿ Pockets: 1 Fat Eighth (or scraps from *the Anne handbag*)
- ✿ 1 Fat Quarter Cotton Flannel
- ✿ 1/8 yard medium weight fusible interfacing
- ✿ 1 - 9" zipper
- ✿ 1 ½" Swivel Clip & ¾" D-Ring
- ✿ Machine Quilting cotton thread & notions
- ✿ Zipper Foot & (Optional) Ruffler Foot

Skill Level: Advanced Beginner. **Fabric shown:** *Cold Spring Dreams* by Mary McGuire for RJR Fabrics.

Notes:

- ✿ Read all directions before beginning.
- ✿ All fabric is estimated at 42" wide (WOF = Width of Fabric).
- ✿ All seam allowances are ¼" unless otherwise noted. While cutting instructions for yardage are listed, we recommend piecing the body of the bag before cutting yardage because some jelly roll strips and seam allowances may vary.
- ✿ RST=Right Sides Together; WST=Wrong Sides Together
- ✿ Visit <http://www.cloverandviolet.com/pattern-corrections> to check for any corrections or updates.
- ✿ Please e-mail questions to: office@cloverandviolet.com

Cutting Instructions:

From Anne bag lining fabric **OR** Fat Quarter:

- ✿ Cut two 10 ½" x 7 ¾" rectangles for lining
- ✿ Cut one 2" x 15" strip for handle & D-ring
Note: If a different size D-Ring & Clip are used, adjust handle width to match.
- ✿ Cut two 1 ½" x 3" rectangles for zipper tabs

From fat eighth:

- ✿ Cut two 10 ½" x 4 1/2" rectangles

OR

From Anne bag scraps:

- ✿ Cut four 10 ½" x 2 ½" rectangles

From flannel:

- ✿ Cut one 11" x 13" rectangle

From interfacing:

- ✿ Cut two 2" x 8 ½" rectangles for band



1. Quilted Outside:

Sew the five 2 ½" x 13" strips together to form one 10 ½" x 13" rectangle. Cut in half (two 10 ½" x 6 ½" rectangles). With right sides together (RST), sew front and back rectangles together, reversing pieced pattern and lining up strip seams, press seam open. This seam is the bottom of the bag. (See Figure 1 for sample layout.) Pin and quilt the patchwork portion to the 11" x 13" piece of flannel. Flannel will slightly overhang the patchwork portion, trim to 1/8" from patchwork after quilting.

To make gathered edge, set your sewing machine to longest stitch length and stitch ¼" along one 10 ½" edge, leaving a long tail of thread. Pull one thread to gather the fabric to 8 ½", distributing gathers evenly (Optional: use a ruffler foot)(Figure 2a).

Following manufacturer's directions, fuse one 2" x 8 ½" rectangle of interfacing to the **wrong** side of one 2" x 8 ½" band rectangle. Sew the rectangle RST to the gathered edge of the patchwork body (Figure 2b).

Press the gathered seam toward the band and top stitch in place 1/8" from the seam on the band portion of the bag (Figure 2c). Repeat for other 10 ½" edge.



2. Handle & D-Ring Loop

Fold the 2" x 15" strip in half long ways, RST, and sew along the long side, back stitching at beginning and end. Turn right side out, press, then top stitch 1/8" from each edge. Finished size should be 3/4" wide by 15" long.

Cut strip into one 3" long piece and one 12" piece. Slip the D-Ring onto the 3" piece, fold in half, and sew to the side of one band piece on the clutch (Figure 2d).

Slip the Swivel Clip onto the 12" long piece. Sew the two short edges together, finishing the edge with a zig-zag stitch (Figure 3a). Turn right sides out and slide the Swivel Clip to the seam. Use the zipper foot to stitch 3/8" from the seam, sewing the Swivel Clip into place (Figure 3b). Set aside.



3. Shaping the Lining:

On one 10 1/2" x 7 3/4" rectangle, measure 1" from one top corner, then use a ruler to draw a diagonal line, along the 7 3/4" side, from the mark to the bottom corner (Figure 4a). Repeat for other side. Cut along line to create a trapezoid (Figure 4b). Repeat with second 10 1/2" x 7 3/4" rectangle.

4. Construct Inside Pockets:

Use the 10 1/2" x 4 1/2" rectangles for pockets. Fold one rectangle in half long ways, RST, and sew 1/4" from the raw edge, then turn right side out like a tube, press, for a finished size of 10 1/2" x 2". Top stitch 1/8" from the folded edge. *If using scraps from the Anne handbag, sew two 2 1/2" x 10 1/2" strips, RST, along both long edges, then turn right side out like a tube, then top stitch along one sewn edge.* Repeat for second pocket.



Use a water soluble or other disappearing pen to draw a line down the middle of the rectangle (or divide pocket as desired). Then, position the rectangle three inches from the top of the lining and stitch in place along the bottom of the pocket and down the center line. Trim the sides of the pocket to match the lining (Figure 3c). Repeat with the other pocket on the other side of the lining.

5. Insert the Zipper:

Note: for a more detailed look at inserting this type of zipper, visit: <http://www.cloverandviolet.com/2012/10/zippers-101-basic-zipper-pouch.html>

Take the two 1 ½" x 3" rectangles, fold in half (1 ½" x 1 ½"), **WST**, press. Then, fold the raw edges toward the center. Cut zipper to about ½" shorter than the length of top of clutch (about 7 ½"), then sew folded rectangles to both ends. Note: the zipper edge should be tucked about ⅜" into the zipper tabs, but should not reach all the way to the fold so that the zipper does not get caught in the size seam allowance. Back stitch to secure (Figure 5a).

Place zipper face down on the patchwork outside (Figure 5b), making sure that when the zipper is closed the zipper pull is on the same side the D-Ring (in the sample clutch, it is on the left, as shown in Figure 5d).

Place one lining piece RST on top of the zipper (Figure 5c), pin in place and sew along the top edge (Note: do not sew too close to zipper teeth or the lining might get caught in the zipper when you use the pouch). When sewing zipper in place, adjust the location of the zipper pull (open or close zipper as you sew) to get an even seam line. Turn pieces right sides out (Figure 5d).

Layer second lining on top of zipper, and sew in place as for first zipper side.

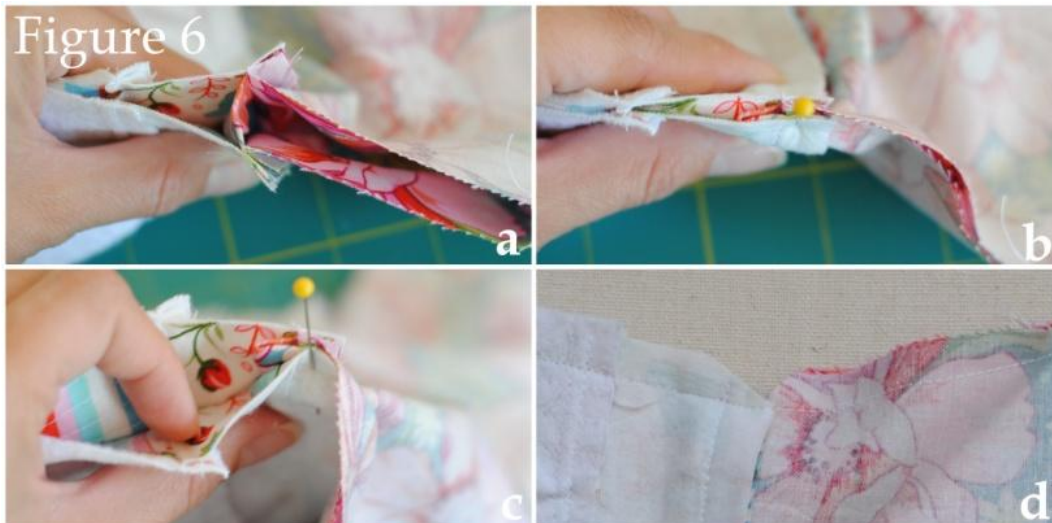

6. Construct Pouch:

Place the patchwork pieces and lining pieces of the clutch right sides together matching up the seams (Figure 7a), make sure to leave the zipper partially unzipped. For the zipper ends (Figure 6a), fold the seams towards the lining and the zipper tab towards the outside. Pin in place (Figure 6b & C), and then, sew along your side seam, catching the edge of the tab in the seam. Clip the corner, being careful not to clip into the seam line (Figure 6d).

Sew along both sides and across the lining bottom with a $\frac{3}{8}$ " seam allowance, leaving a 5" opening in the lining bottom seam (Figure 7a).

7. Box the corners & finish:

While still inside out, match side and bottom seam of one corner of the patchwork body to form a triangle on the corner, press flat. Measure 1" from point and draw a line. Sew along line (Figure 7b) and trim point $\frac{3}{8}$ " from seam (Figure 7c). This creates a box on the bottom of the bag, repeat on remaining body corner and both lining corners (Figure 7d).

Turn the bag right side out and stitch opening in lining closed (Figure 7e), then tuck lining inside bag and carefully push zipper corners out. Attach the handle swivel clip to the d-ring. Enjoy!

Terms of Use:

This pattern is for personal, non-commercial use only. If you're interested in selling items made from this pattern, please purchase a tutorial license. Thanks!

