

# CLOVER & VIOLET

## *the Poppy clutch*



The Poppy Clutch is perfect for an evening out, a quick trip to the store, or carrying some on the go essentials in a larger bag. It is large enough to still fit a wallet and other accessories. The front features a zipper pocket to keep important items separate from the inside. *Share on social media with the tag #poppyclutch*

### *Materials*

- 1 Fat Eighth (Main Print)
- 2 Fat Quarters
- ½ yard prewashed cotton flannel
- 1 yard medium weight fusible interfacing – Such as Pellon® Shape-Flex® SF101
- 1—10” zipper
- 1 – 14” zipper
- Machine Quilting cotton thread & notions
- Zipper Foot

*Skill Level* Advanced Beginner

*Fabric* Flora by Kelly Ventura for Windam

## Notes

- Read all directions before beginning.
- All fabric is estimated at 42" wide, interfacing is estimated at 20" wide (WOF = Width of Fabric).
- All seam allowances are ¼" unless otherwise noted.
- RST=Right Sides Together; WST=Wrong Sides Together
- Visit <http://www.cloverandviolet.com/pattern-corrections> to check for any corrections or updates.
- Please e-mail questions to: [office@cloverandviolet.com](mailto:office@cloverandviolet.com)
- **Why flannel and interfacing?** We have tried a variety of different types of interfacing and methods; the interfacing and flannel combo is our favorite because the quilting doesn't make the bag look puffy (as with fusible fleece or batting that is quilted), but still reinforces it and provides a quilting medium. It also makes the bag sturdy, yet still soft and flexible.

## Cutting Instructions

### From main print:

- Cut two 10" x 7 ½" rectangles (main body)

### From accent & lining print:

- Cut two 4" x 7 ½" rectangles (body accent)
- Cut two 13 ½" x 7 ½" rectangles (lining)

### From pocket print:

- Cut one 10" x 11 ½" rectangle (zipper pocket)
- Cut two 2" x 2 ½" rectangles (top zipper tabs)

### From flannel:

- Cut two 13 ½" x 7 ½" rectangles (body)

### From interfacing:

- Cut four 13 ½" x 7 ½" rectangles (body & lining)

*Note: Before beginning, fuse the lining interfacing to the wrong side of the lining pieces.*

### 1. Quilted Outside

Sew the body accent piece to the left of the main body piece. Following the manufacturer's instructions, fuse the body interfacing to the wrong side of the body. Place the body flannel on the wrong side of the body piece and quilt as desired. We quilted in randomly placed straight lines.

Repeat with second body piece, sewing the accent to the right side of the body.

*Optional: Instead of quilting, fuse a second layer of interfacing to the wrong side for a sturdier body without a quilted look.*



## 2. Inside Zipper Pocket

Draw an 8" x  $\frac{3}{8}$ " rectangle on the **wrong** side of pocket piece 1" below and centered on one 10" edge. Pin pocket piece, RST, 1/2" from the top of the body piece (Figure 2a). Sew around the rectangle through the pocket piece and the body (Figure 2b). Cut a straight line  $\frac{1}{4}$ " from each short edge of the rectangle and then clip towards the corners (Figure 2c). Push the pocket fabric through the opening (Figure 2d). Press thoroughly to create a window for the zipper (Figure 3a). For an added accent, we allowed some of the zipper pocket fabric to show through the window. This allows for easier pressing and gives an added feature.

*Optional: For easier placement, use a fabric adhesive (such as Steam-a-Seam®) to keep zipper in place while sewing (Figure 4b).*

Place the zipper in the opening, and fuse or pin in place. Using a zipper foot, on the front side of the body, sew next to the opening to secure the zipper in place, double stitching the ends (Figure 3c). Turn the body piece over; trim the zipper to width of pocket if necessary. Fold the pocket piece in half and pin. Carefully stitch along the top and sides of pocket, making sure not to stitch through the body (Figure 3d).

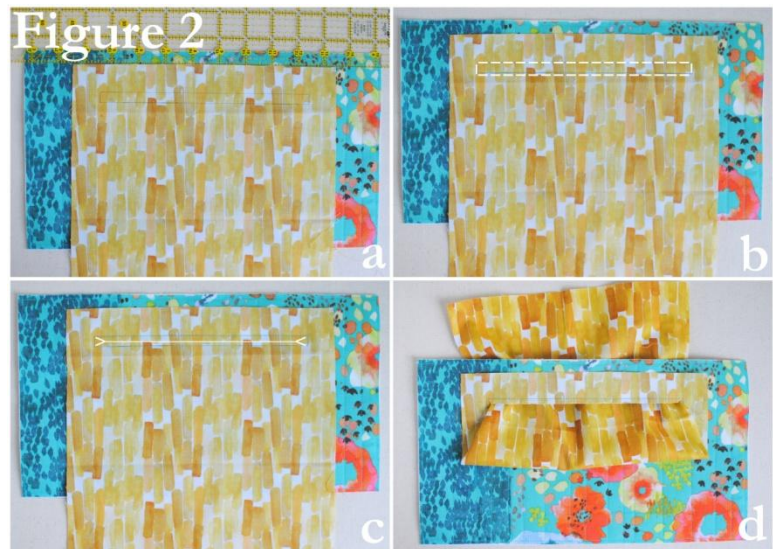



### 3. Shape Body and Sew Corners:

Line the top and bottom of the pattern piece up with the top and bottom of one side of the body piece (Figure 4a). Trim the side and curve, and then reverse the pattern piece to trim the other side of the body (Figure 4b).

Fold the corner along the cut “V” and sew with slightly less than a  $\frac{1}{4}$ ” seam allowance (Figure 4c). Repeat with the second side of the body piece to shape the corners (Figure 4d).

Use the same method to trim and sew the corners on the second body piece and both lining pieces

### 4. Insert the Top Zipper

Fold the two zipper tabs in half ( $1\frac{3}{4}$ ” x 2”), wrong sides together, press. Then open and fold the short edges  $\frac{1}{4}$ ” toward the center (Figure 5a). If necessary, trim the zipper to  $\frac{1}{2}$ ” shorter than the width of the top of the clutch (approximately  $12\frac{1}{2}$ ”). Place the zipper end so that it extends  $\frac{3}{8}$ ” past the fold of the tab, but not all the way to the center (Figure 5b). Sew the tab over the edge of the zipper and trim to zipper width (Figure 5c). Repeat for other zipper end.

*Tip: For easier placement, use a fabric adhesive (such as Steam-a-Seam®) to keep zipper in place while sewing.*

Place zipper face down the body piece with the zipper pull on the left (Figure 5d). Place one lining piece RST on top of the zipper. Sew along the top edge. Turn pieces right sides out.

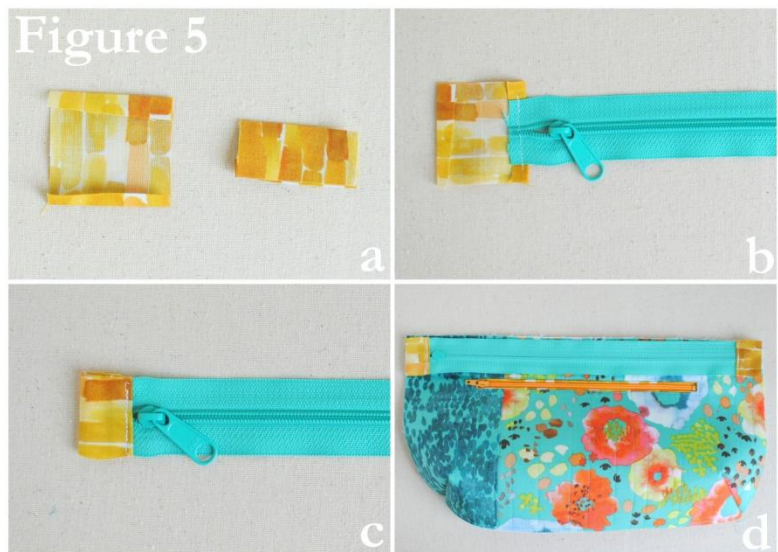
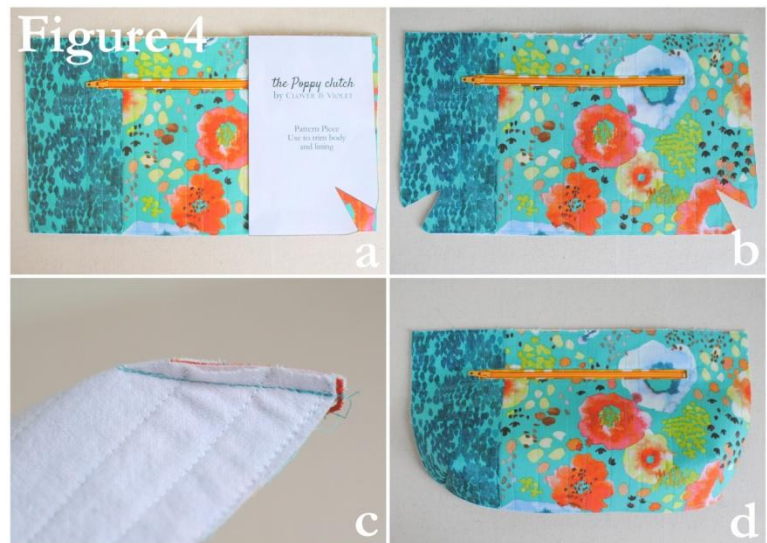

Press thoroughly or top stitch the zipper to the lining to prevent the lining from getting caught in the zipper (Figure 6a).

Place the front body piece on the back body piece, RST (Figure 6b). Lay second lining on top of zipper. Sew in place as for first zipper side.

### 5. Construct the Bag

Fold bag so the patchwork is RST and lining is RST together. Make sure the zipper is partially unzipped before sewing. At the zipper tabs, fold the tab toward the body and the raw edges toward the lining (Figure 6c). At the corners, press the seams so they are in opposite directions and nest together (Figure 6d). Press the seams on the piece with the pocket away from the pocket (Figure 7a). Sew around the outside and leave a 6" opening along bottom of lining (Figure 7b). Trim the seams next to the zipper. Turn the bag right side out and stitch opening in lining closed (Figure 7c). Tuck lining inside bag and enjoy your new clutch (Figure 7d)!

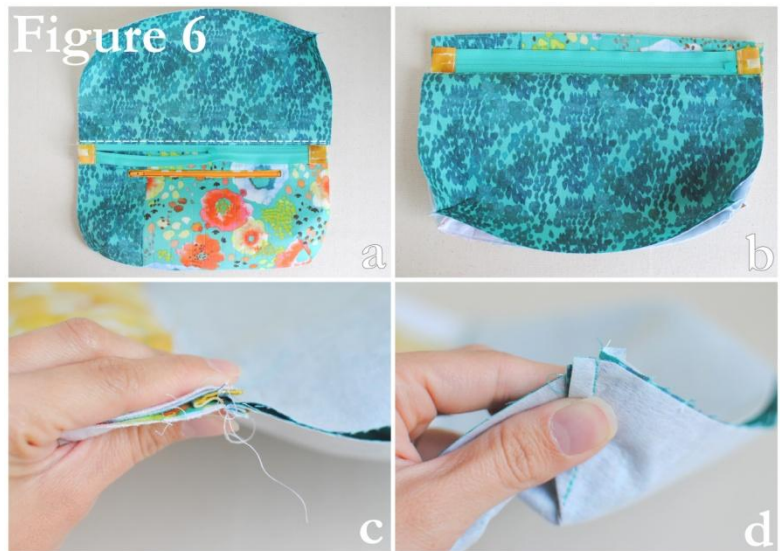

### Terms of Use:

This pattern is for personal, non-commercial use only. If you wish to sell items made from this pattern, please contact us to purchase a license. Thank you for supporting our business.

*the Poppy clutch*  
by CLOVER & VIOLET

Pattern Piece  
Use to trim body  
and lining

Scale  
=1"

